

Toilet Pan

Wall Faced, Type 3

The Wall Faced, Type 3 Toilet Pan from Stoddart Manufacturing has the most water efficient dual flush rating (certified by Wels for 4.5L full flush and 3L half flush) in Australia.

This unit reduced maintenance costs, water usage costs and is the right choice for use in all high security prisons, detention centres, police stations, hospitals and public amenities.

Vandal resistant, fully welded stainless steel construction provides superior strength, superior hygiene and long service life.

The toilet seat is hydraulically formed to create a safe, strong, comfortable contoured and self draining profile.

The standard option has secured side access covers. A rear access option is available, this is ideal for high security prisons and detention centres.

Models:

SPPL.TP.WF.3.X.YY.ZZZ

Code explanation:

SPPL	= Standard Product Plumbing
TP	= Toilet Pan
WF	= Wall Faced
3	= Type 3
X	= S – Standard height = D – Disabled height
YY	= S – Standard spec = H – Heavy duty
ZZZ	= BSA – Both sides access = LSA – Left side access = RSA – Right side access = RA – Rear access

e.g.: for specification and ordering

SPPL.TP.WF.3.D.S.BSA

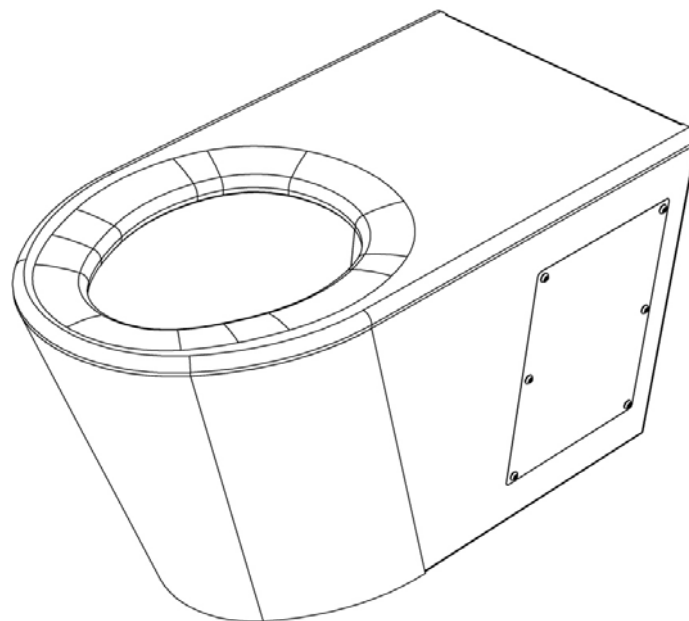

Features and Benefits:

- Standard unit has 2mm stainless steel shroud and formed seat for superior hygiene and strength.
- Optional heavy duty (HD) specification has 3mm toilet seat.
- Plumbing and fixing points are concealed for security and vandal resistance.
- Access to plumbing is via side access panels (except for RA variation for cells with rear access service ducts).
- Toilet pan seat has an anti-contraband flushing rim for effective cell inspection.
- Seat has smooth hydraulically formed radius to both outer and inner edges for safety and comfort and has a self draining seat surface for improved hygiene.
- All external corners are rounded with a smooth radius for user safety.
- These toilets can be installed with either a flush valve or cistern (order separately).

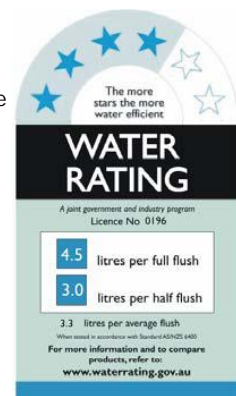

Due to continuous product research and development, the information contained herein is subject to change without notification.



Toilet Pan

Wall Faced, Type 3

Specifications:

Construction: Toilet bowl & Trap – 304 stainless steel.
Seat, Body and shroud – 2.0mm 304 stainless steel
Optional Heavy Duty: Seat – 3.0mm

Flushing: Electronic flush, WELS approved 4.5L full flush/3L half flush.
20mm mains connection for flush valve. Installed valve should have water pressure regulated between 250kPa and 500kPa and have a flow rate between 1.2 and 1.5 Litres/s at the valve face.
RAG should be mounted 450mm above seat.
Cistern should be 1150mm to top of cistern.

Water Connection: 60mm i.d. inlet with Kee-Seal for 40mm PVC.

Waste Connection: P trap standard, 95mm OD stainless steel spigot with rubber coupling included to suit 100mm PVC or copper sewer pipe.
Optional P-S adaptor can be ordered separately.

Unit fixing: The unit is designed to be fixed to the rear wall with 4 bolts. A Z-clip is supplied to secure the front of the base to the floor.

Models:

SPPL.TP.WF.3.X.YY.ZZZ

Code explanation:

- SPPL = Standard Product Plumbing
- TP = Toilet Pan
- WF = Wall Faced
- 3 = Type 3
- X = S – Standard height
= D – Disabled height
- Y = S – Standard spec
= H – Heavy duty
- ZZZ = BSA – Both sides access
= LSA – Left side access
= RSA – Right side access
= RA – Rear access

e.g.: for specification and ordering

SPPL.TP.WF.3.D.S.BSA

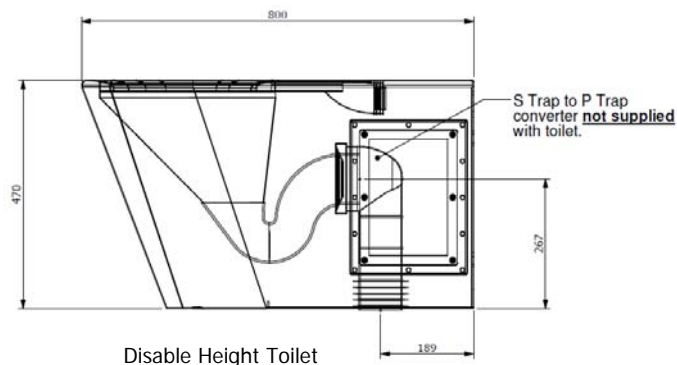
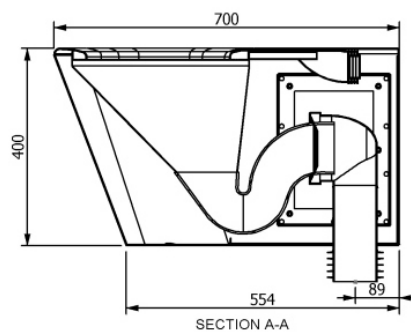
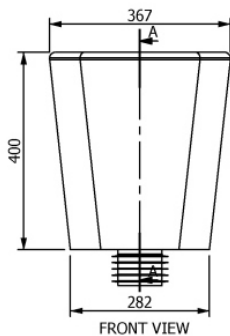
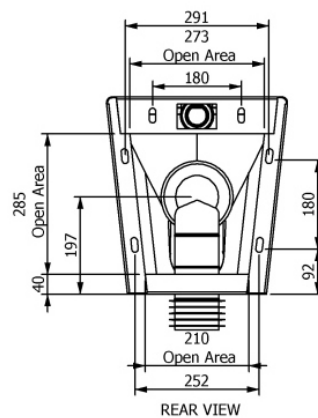
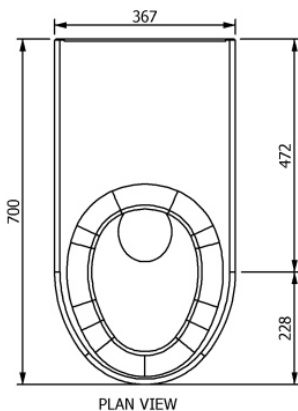

Description	Model No.	Length (mm)	Height (mm)	Waste Set-out Std Bend	Waste Set-out Q Bend
Standard	SPPL.TP.WF.3.S.S.BSA	700	400	88	138
Disabled	SPPL.TP.WF.3.D.S.BSA	800	>460	188	238
Ambulant Disabled	SPPL.TP.WF.3.A.S.BSA	650	>460	NA	88
Rear Access 550 long	SPPL.TP.WF.3.S.S.550	550	400	NA	NA

Due to continuous product research and development, the information contained herein is subject to change without notification.