



Drinking Fountain Round

Wall Mounted

Wall Mounted Drinking Fountain with push button drinking bubbler is the approved design drinking fountain for government schools. The Compound mouth guard protects teeth from damage. The material is resistant to sunlight and bacteria. The bubbler is angled to provide water over the centre of the bowl for easy access.

The Round Wall Mounted Drinking Fountain can be mounted at heights to suit the application.

Models:

SPPL.DF.R.WM.300

Code explanation:

SPPL = Standard Product Plumbing

DF = Drinking Fountain

R = Round

WM = Wall mounted

300 = 300mm Splashback (optional)

e.g.: for specification and ordering

SPPL.DF.R.WM (tiled upstanding edge as shown)

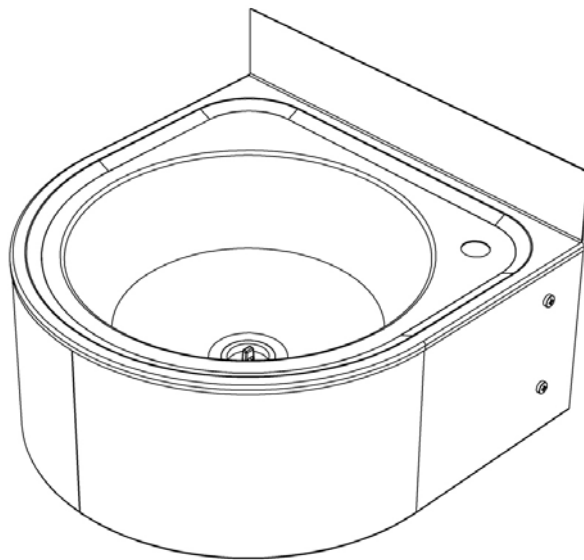

Galvin Ezy Drink Bubbler supplied with standard unit.

Features and Benefits:

- Economical design makes this the affordable solution for schools and institutions.
- Easy mount bracket system for quick installation
- Excess water is drained & can be connected to a rubble pit, a nearby garden bed or, with the addition of a trap, it can be connected to grey water.
- Wels rated bubbler for easy and efficient water access
- No sharp edges to ensure safety in use and cleaning.
- Sturdy and attractive stainless steel construction for years of hygienic, trouble free service.



WaterMark
AS/NZS 3718 Lic. WMKA0034
SAI Global
For Easy Drink Tap



Due to continuous product research and development, the information contained herein is subject to change without notification.



Drinking Fountain Round

Wall Mounted

Specifications:

- Construction:** Fully welded 304 grade stainless steel construction, no 4 satin finish.
Approved design for Government Schools
- Water Supply:** Single 15mm (1/2" BSP).
- Waste Connection:** 40mm waste connection. Excess water can be drained to a rubble pit, a nearby garden or, with the addition of a trap, it can be connected to grey water.
- Unit Fixing:** The unit is supplied with a stainless steel wall mounting bracket with 8mm diameter fixing holes. The fountain is fixed to the bracket with 6mm stainless steel fixings.

Models:

SPPL.DF.R.WM.X

Code explanation:

- SPPL = Standard Product Plumbing
 - DF = Drinking Fountain
 - R = Round
 - WM = Wall mounted
 - X = 300 – 300mm Splashback (optional)
- e.g.: for specification and ordering

SPPL.DF.R.WM.300

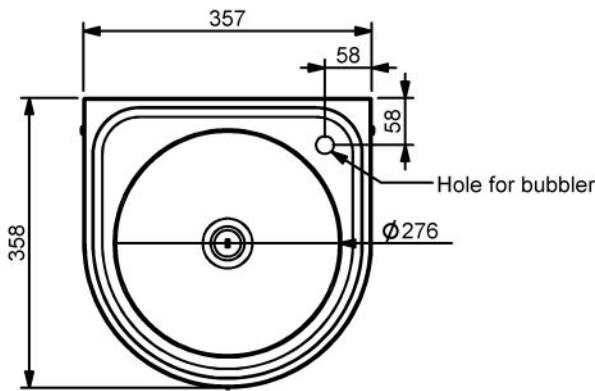

PLAN VIEW

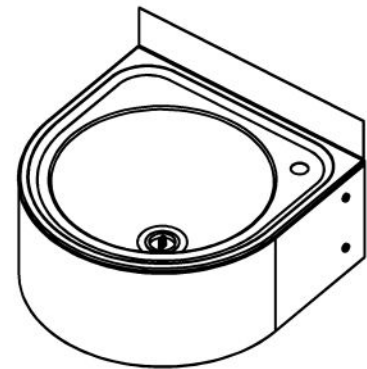

ISOMETRIC VIEW

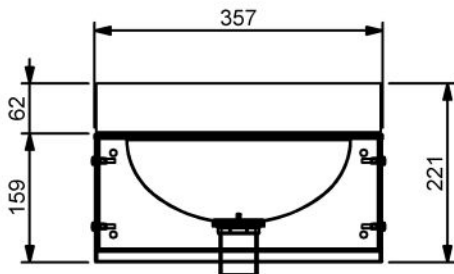

FRONT VIEW

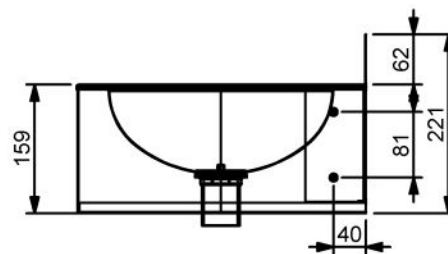

END VIEW

| Model No. | Length (mm) | Width (mm) | Height (mm) |
|-----------|-------------|------------|-------------|
| SPPL.DF.R | 356 | 357 | 159 |

Due to continuous product research and development, the information contained herein is subject to change without notification.